



KING  
50  
STREET

REGENT  
ESTATES

# KING STREET, TRING

£525,000 Freehold

---

## ACCOMMODATION

A deceptively spacious, three bedroom end of terrace home situated centrally in the Conservation Area, benefiting with a garage and offered to the market with no upper chain.

The property is set back from the road by a small front garden and pathway leading up to the porch.

Downstairs, the open-plan accommodation is well presented and in good condition throughout. The generous sitting room is at the front, with double doors flowing through and opening into the kitchen / dining room to the rear. From the kitchen patio doors open out on to the rear garden.

Upstairs, the property has three bedrooms, two of which are double rooms, and a well appointed family bathroom completes the accommodation.

The south facing rear garden is mainly laid to lawn with a large patio area off the patio doors. From the rear garden, there is also access to the garage located at the rear of the property.

## LOCATION

## OUTSIDE

## IMPORTANT NOTICE

1. These sales particulars have been prepared from information supplied by the vendors and information collated by Regent Estates.
2. Confirmation has been sought from the vendors to confirm these particulars accuracy.
3. All measurements given have a tolerance of 3" in accordance with RICS Code of Measuring Practice.
4. None of these appliances, plumbing or electrics mentioned within these particulars have been tested by ourselves, prospective purchasers are urged to check their condition before entering in to purchase.

## VIEWING

Strictly by appointment through Regent Estates.

01442 877878  
141-143 High Street, Berkhamsted, Herts,  
HP4 3HH

Email: [info@regent-estates.com](mailto:info@regent-estates.com)  
[www.regent-estates.com](http://www.regent-estates.com)







**Ground Floor**  
Approx. 51.9 sq. metres (558.9 sq. feet)

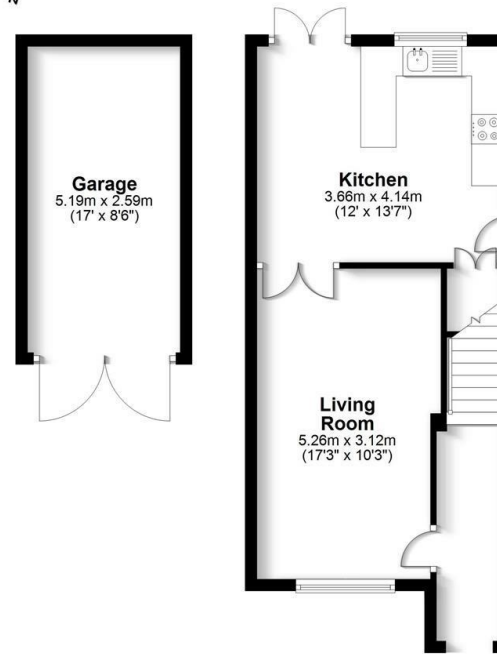

**First Floor**  
Approx. 37.3 sq. metres (402.0 sq. feet)

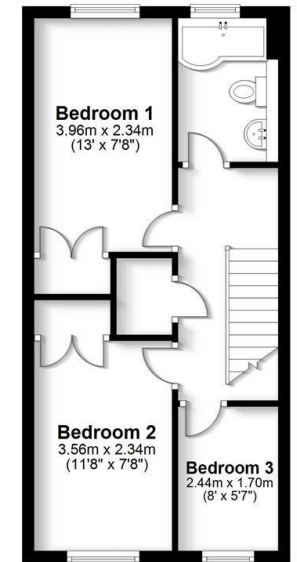

**Total area: approx. 89.3 sq. metres (960.9 sq. feet)**

FOR ILLUSTRATIVE PURPOSES ONLY - NOT TO SCALE - The position and size of doors, windows, appliances and other features are approximate only. Total area includes garages and outbuildings - © My Home Property Marketing - Unauthorised reproduction prohibited. Plan produced using PlanUp.

**REGENT  
ESTATES**

TELEPHONE: 01442 877878  
141-143 High Street, Berkhamsted,  
Herts, HP4 3HH  
Email: info@regent-estates.com  
www.regent-estates.com